

# HOW TO MEASURE

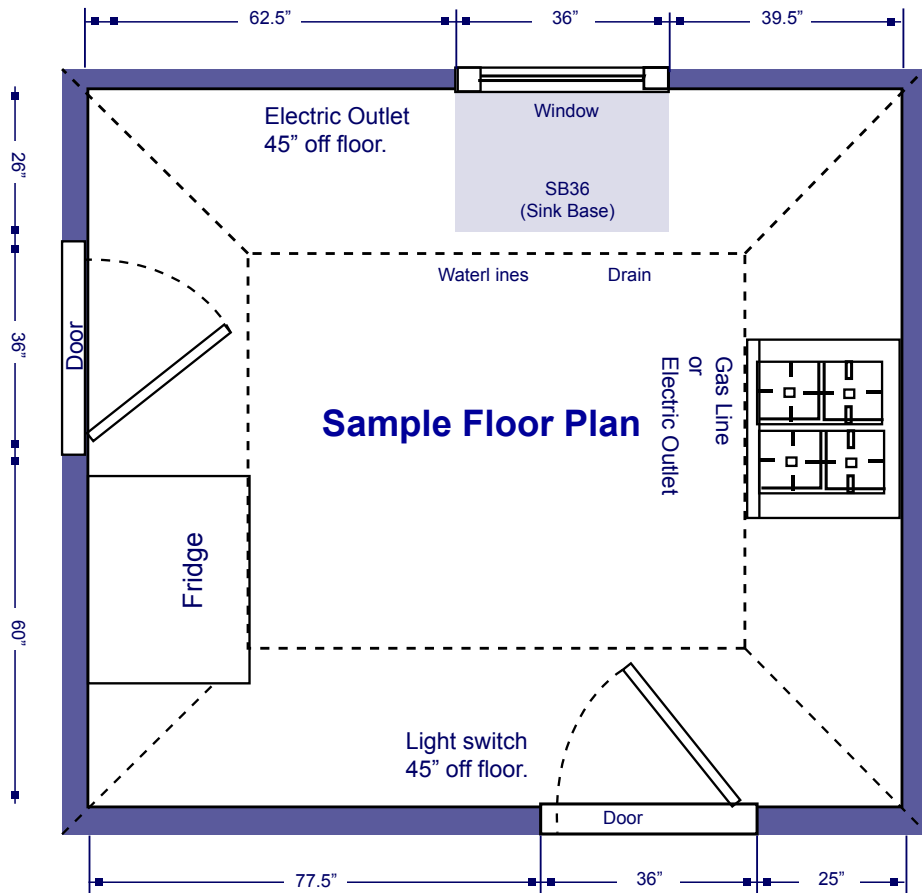

1. Draw a rough sketch of your room on a separate sheet of paper as illustrated here. Once all the measurements are accurate, transfer the information to a grid of paper.
2. Measure in inches only, not in feet and inches.
3. Measure openings, such as door and windows, from outside trim edge to outside trim edge.
4. Indicate which way the doors swing on your drawing.
5. Measure the full length of each wall.
6. Measure the wall in segment.
  - a. Wall to outside trim edge of window or door.
  - b. Outside trim edge to outside trim edge of window or door.
  - c. Outside trim edge of window or door to wall.
7. Check your overall dimensions. The measurements in step 6 should add up to the overall wall measurement.
8. Locate and note on your layout the exact location of the following: sink, water lines, drains, gas lines, electrical outlets, heat and air conditioning vents, switches, appliances, and soffit height and depth.
9. Double-check your measurements!
10. Getting new appliances? Include the manufacturer name and model number of each new appliance.
11. If you are just duplicating your existing layout with new cabinetry include a rough sketch of your current cabinet layout.
12. Have a dream list, like having a lazy susan or having more drawers than you currently have? Make a list of what you would like to have included in your new kitchen.
13. Have pictures? include those with your drawing. It's always fun to have before and after pictures.
14. Any questions? Please don't hesitate to call or email. Your questions. We are here to help you make your job easier. (520) 461-1570 or [info@summitproductsus.com](mailto:info@summitproductsus.com)

